



**504/1 The Piazza Wentworth Point NSW**

1  1  1 

Enjoying a private elevated position, this spacious one-bedroom apartment promises easy-care living in an unbeatable lifestyle location. Offering light-filled interiors with welcoming open plan living and dining spaces, leading out onto a large wrap-around entertaining balcony with tree-line vistas.

**Type** : Apartment  
**View** : <https://www.landmarkrealtygroup.com.au/lease/nsw/inner-west/wentworth-point/residential/apartment/8003968>

- \* Spacious light-filled living and dining area spills to outside
- \* Covered balcony with leafy outlook ideal for alfresco entertaining
- \* Queen sized bedroom with built-in wardrobe
- \* Modern kitchen with stone bench and S/S appliances.
- \* Contemporary bathroom, internal laundry, split system air-con
- \* Security intercom, internal lift access to secure car space



**Eric Chan**  
**02 8221 8819**

[For full version visit the website](https://www.landmarkrealtygroup.com.au)

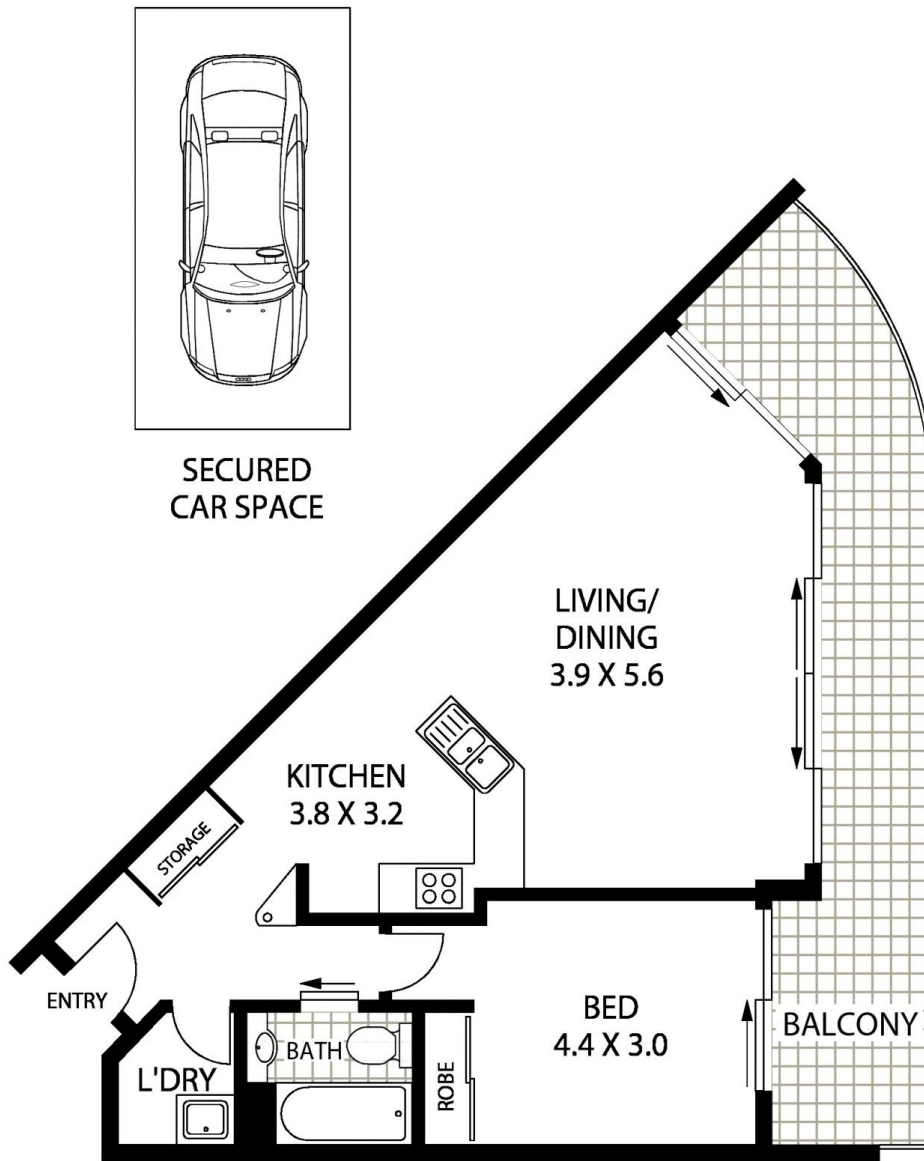

INTERNAL AREA :- 73 SQM ( INCLUDING BALCONY )  
TOTAL AREA :- 88 SQM ( INCLUDING CAR SPACE )



**504/1 THE PIAZZA**

**WENTWORTH POINT**



**Floor Plan Disclaimer:** Mind the Gap (MTG) floor plans / site plans are intended as an approximate guide only. No representations or warranties of any nature are given or intended and any person using this information other than as a guide should always rely on their own enquiries. Contact 1300 133 145 - [www.mindthegap.com.au](http://www.mindthegap.com.au) - Photography, Video, Drone, Interactive, Floorplans, Copywriting.