



2711/98 Joynton Avenue Zetland NSW

2  **2**  **1** 

Located within the burgeoning Zetland precinct, this exceptionally spacious and luxurious split level two-bedroom apartment is brilliantly designed. Offering expansive open plan living and dining spaces with an abundance of natural light, and with each of the bedrooms situated on a separate level for ultra-privacy. Blessed with charm, character and superbly styled interiors the home promises to deliver comfortable and low maintenance living in an undeniable inner-city lifestyle location.

Enjoy the proximity to local parks, Gunyama Park Aquatic Centre, East Village shopping centre, popular boutiques, cafés, restaurants, schools, buses and Green Square Station.

[For full version visit the website](#)

Type : Apartment

Price : \$1150 pw

View : <https://www.landmarkrealtygroup.com.au/lease/nsw/eastern-suburbs/zetland/residential/apartment/8178392>



Eric Chan
02 8221 8819

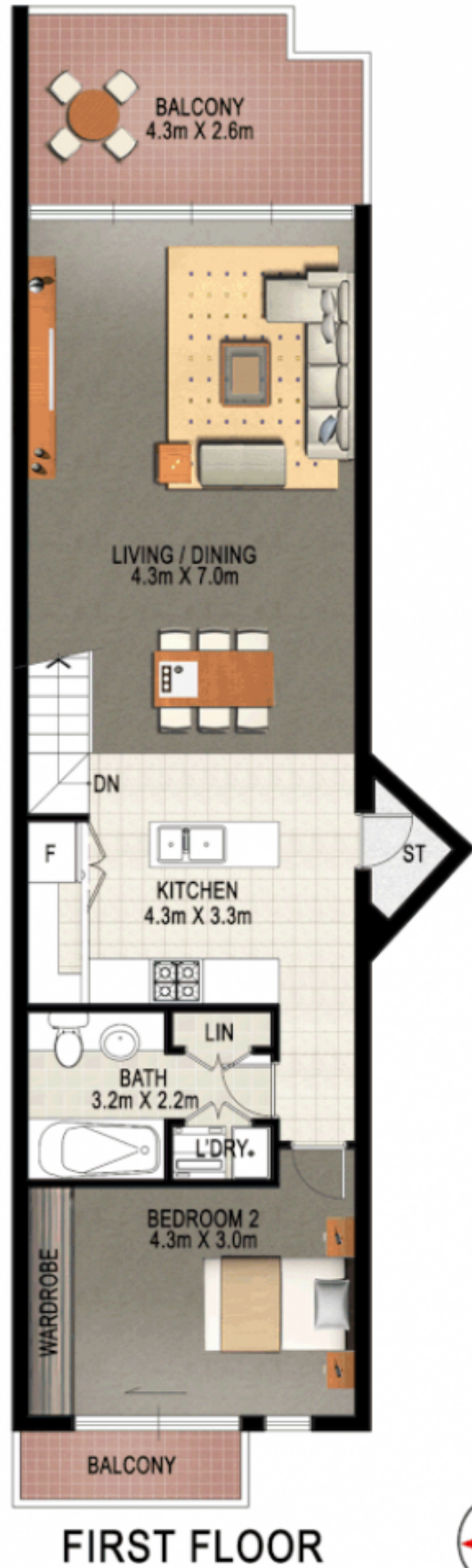
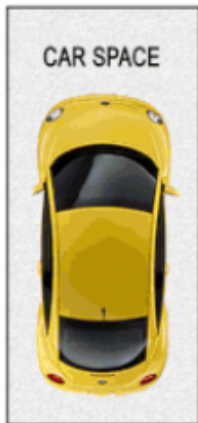

2 2 1

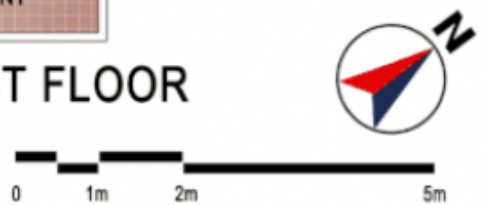

2711/98 Joynton Avenue, Zetland

Disclaimer: Whilst all care has been taken to ensure the accuracy in the preparation of the particulars herein, no warranty can be given, and interested parties must rely on their own enquiries.